



VARIETY CARE



VARIETY CARE

HEALTH CENTERS

- Carol Martin
- Executive Director Community Services

What is an FQHC



- **FQHC = Federally Qualified Health Center**
 - Provides primary care services to underserved areas
 - Must provide a sliding scale discount program
 - Must see all patients regardless of their ability to pay
 - Board must be comprised of 51% patients of the health center
 - **Must Provide Access to**
 - Medical (Family Medicine, Pediatrics, Women's Health)
 - Dental
 - Behavioral Health
- **Federal Grant Funds to Cover the Cost of the Uninsured**
 - Variety Care sees approximately 20,000 uninsured patients each year
 - Grant funds cover the cost of approximately 9,500 patients
 - Leaving over 10,000 patients that have little to no support

Oklahoma Community Health Centers

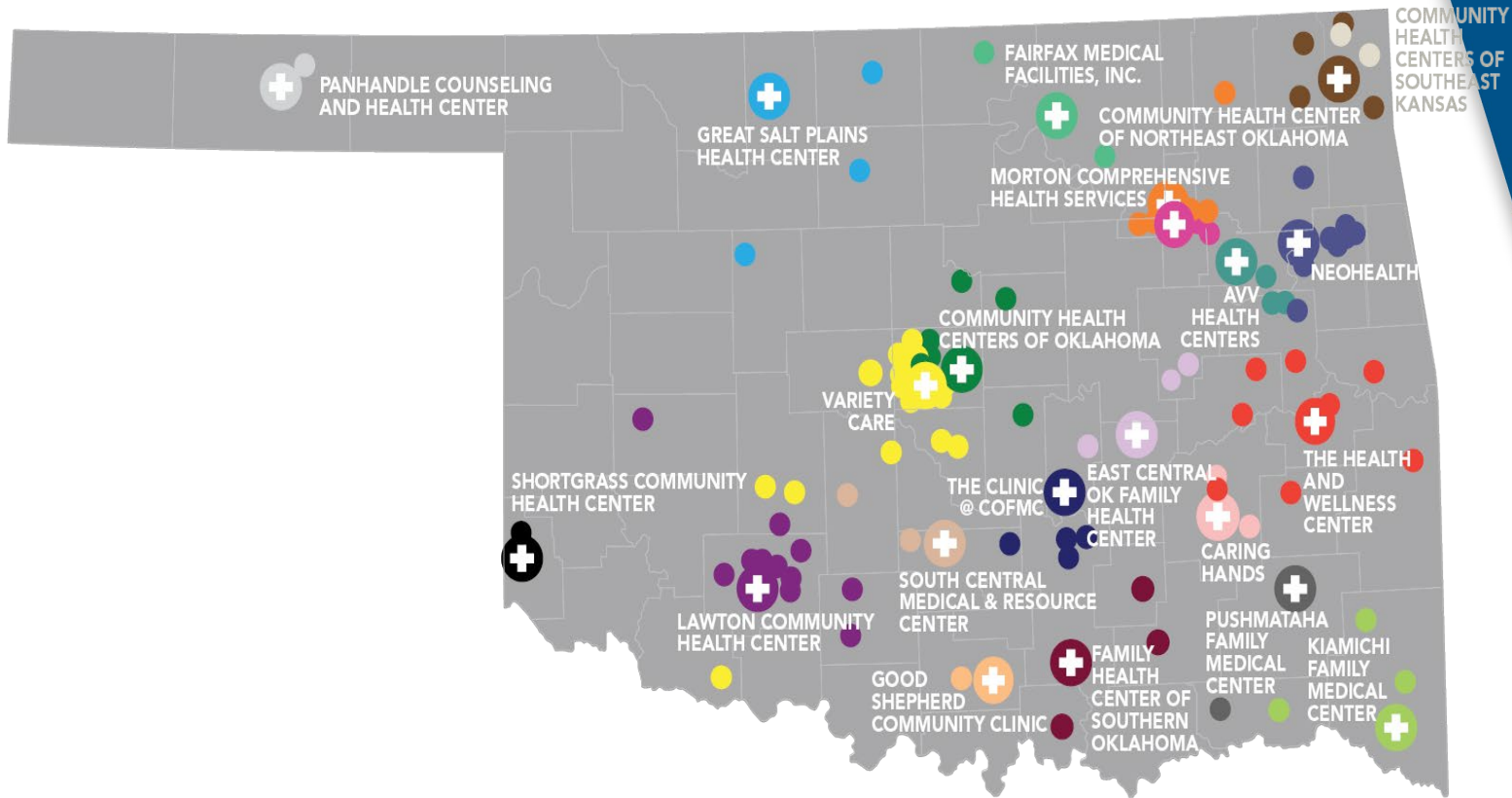

22 FQHC's OPERATING OVER 133 SITES

Community Health Centers Nationwide



Community Health Center Sites

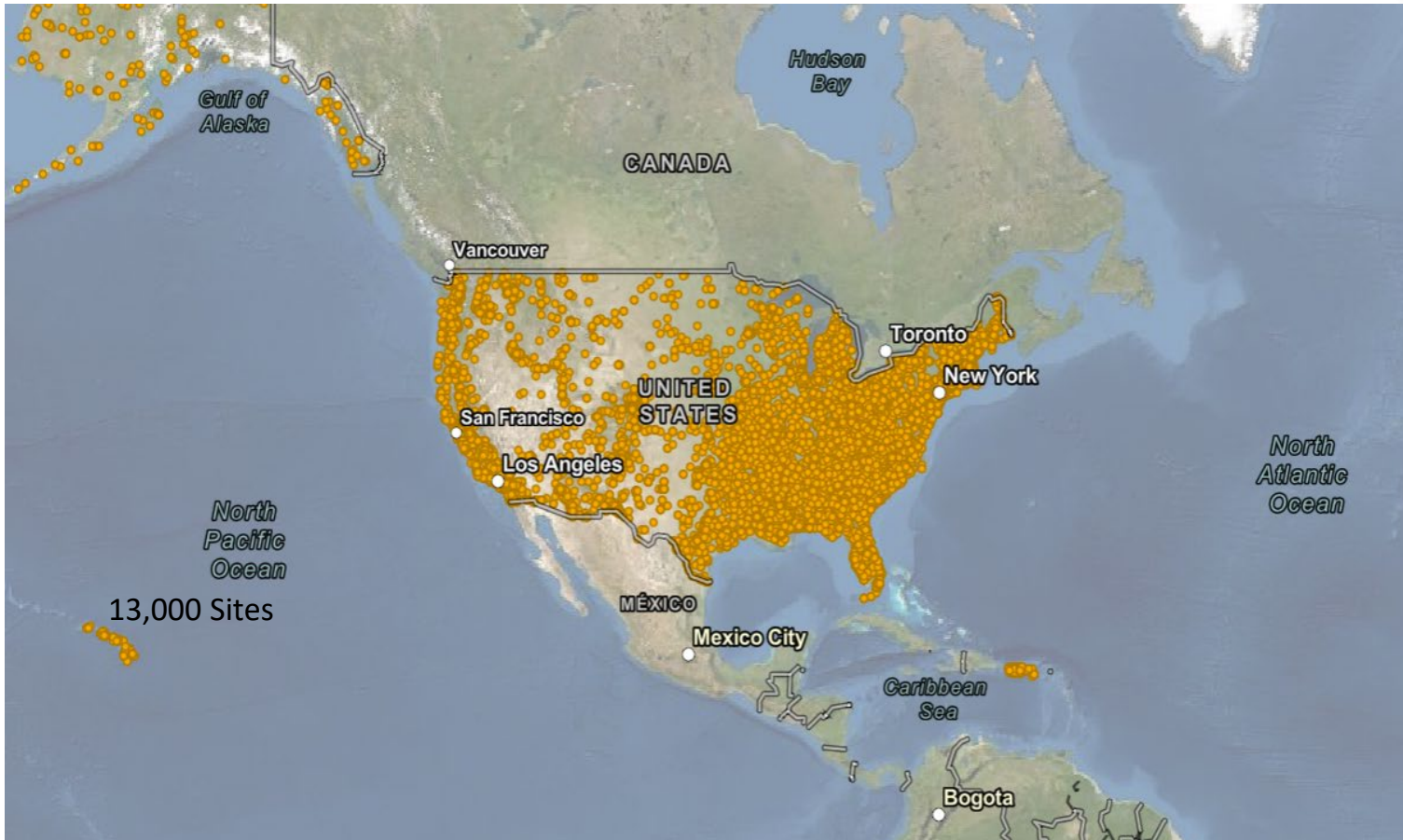

The Struggle in Oklahoma



OK ranks
poorly in
HEALTH
indicators
49th-51st

- Tobacco use during pregnancy
- Childhood immunizations
- Early entry into pre-natal care
- Women incarcerated for non-violent crime
- Violence against women
- % living in poverty especially children and youth
- % of population uninsured
- Obesity
- High prevalence of Teen pregnancy
- Substance abuse and mental illness
- Highest 3+ for ACE in US
- % High School Drop Out

Who FQHC's Serve - The Vulnerable



- **Poor Families**
- **Poor Children**
- **Low Income Pregnant Women**
- **Special Populations**
 - **Racial and Ethnic Minorities**
 - **Elderly Living in Poverty**
 - **Uninsured Adults**
 - **Homeless Youth**
 - **Teenagers**
 - **Children in Custody**
 - **SMI adult patients**
 - **LGBTQ Patient Access**
 - **Addiction**

What they Need to Get Well

One stop shop at affordable prices

Accessible times and convenient locations

Integration, coordination, navigation of the system

Communication, patient education and information toward health and wellness

Discounted Pharmacy

Help and connection with medication assistance and other social services to get well

Mental Health, Dental, and Vision as part of primary care

The Patient Centered Medical Home (PCMH) Care Model

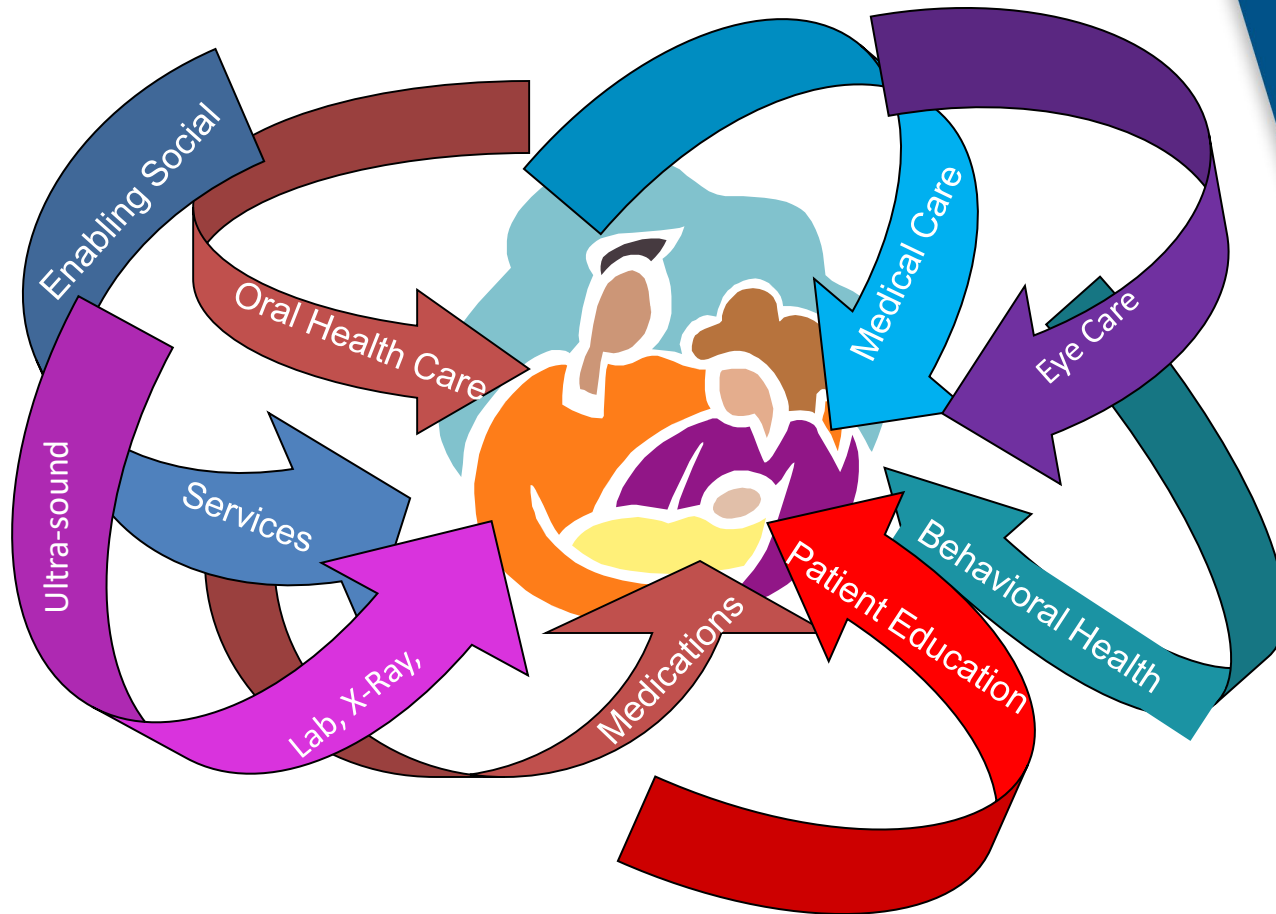

Variety Care History



- **1932 – Variety Health Center**
 - Established by the Junior League during the great depression serving women and children – became a strong United Way Partner in 1960
- **1996 – Oklahoma Community Health Services**
 - Southeast Area Health Center received FQHC designation and later became Oklahoma Community Health Services, moving to our Straka location AKA mothership
- **2009 - Variety Care**
 - Developed from a merger between Oklahoma Community Health Services and Variety Health Center – both with a shared history of serving low income families
- **2018 – Variety Care Expands**
 - Expanded Services into Old Britton, Reno Avenue, Yukon, Anadarko, and most recently in the Putnam school district for a total of 20 delivery sites

Variety Care Expanded Services Board Approval Required



- **Family Medicine** *Required Service*
- **Pediatrics**
- **Women's Health**
- **Adolescent Health**
- **Dental** *Required Service*
- **Urgent Care**
- **Behavioral Health** *Required Service*
- **Psychiatry**
- **Optometry**
- **Nutrition**
- **Pharmacy**
- **WIC**
- **Migrant Farm Workers Program**
- **Social Services**



VARIETY CARE

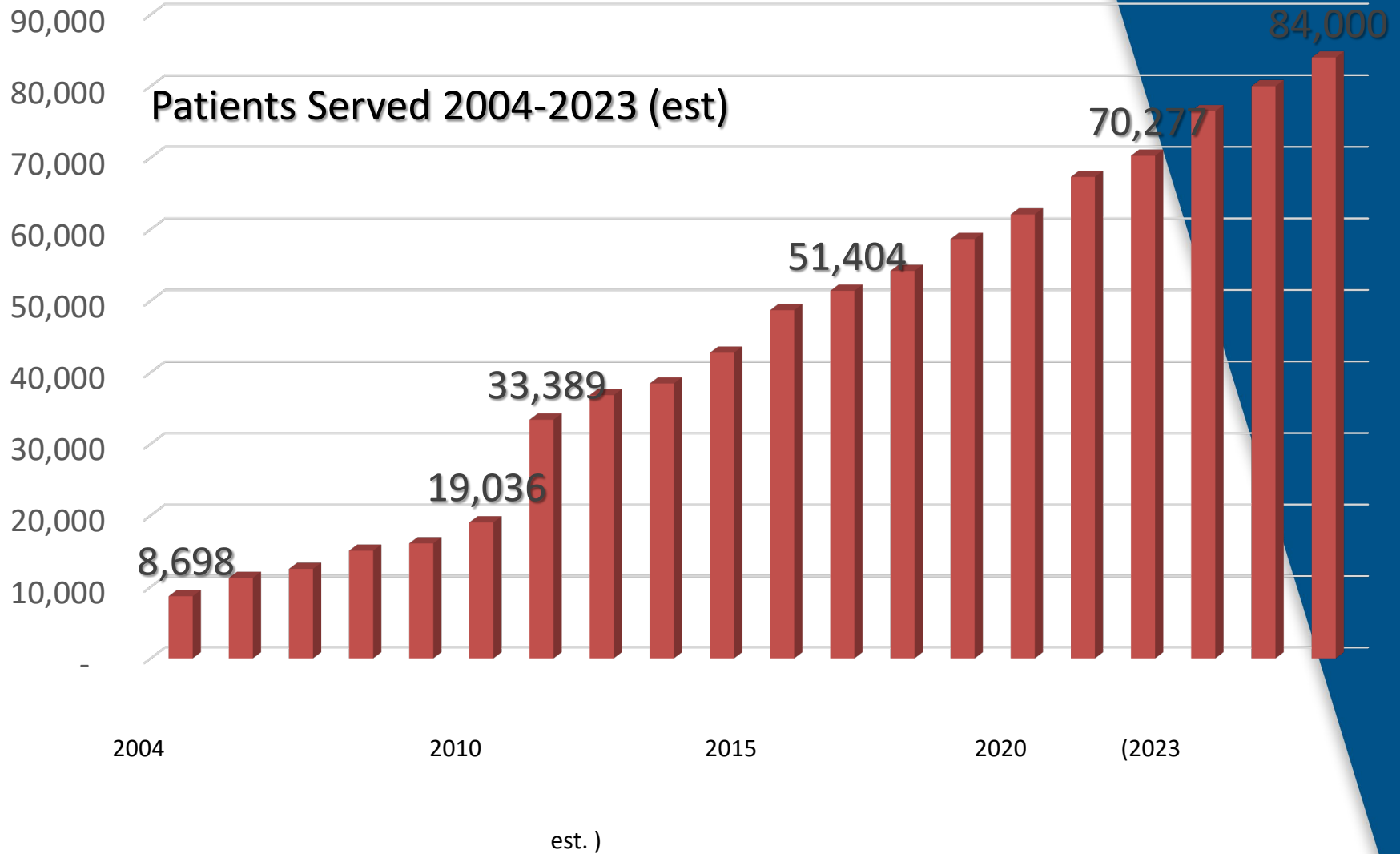

Current Initiatives and Progress



- **EHR Conversion to EPIC August 2022**
- **Several Building and Development Projects**
- **Managed Care Strategy – Value Based Care**
- **Population Health and Empanelment**
- **Online Technology – Home Monitoring**
- **DEI**
- **Crooked Oak Health Center**
- **Norman Expansion**
- **Communications**
- **Staff Morale and Burnout Prevention**
- **COVID Preparation and Vaccine Initiatives**
- **Mobile Health/Dental Care**

Partners are Critical



- Alliance for the Uninsured (Referrals)
- Legal Aid (on site resource)
- North Care (on site)
- Positive Tomorrows (Medical and Dental Care)
- Urban League (Women's Health)
- Remerge (Women's Health)
- YWCA (Referral Partner)
- Early Birds (Referral Partner)
- PIVOT (on site)
- CARE Center (on site)
- Infant Crisis Services (mobile on site)
- Oklahoma City Public Schools (on site)
- Regional Food Bank
- Reach out and Read

Clinic Sites Rural SW Oklahoma



- **Grandfield**
- **Anadarko**
- **Fort Cobb**

Big Pasture
Health Center
Grandfield



Anadarko



VARIETY CARE
HEALTH CENTER





VARIETY CARE



Oklahoma County



- **Straka Terrace**
- **Mid Del**
- **Lafayette**
- **10th Street**
- **North Portland**
- **Baptist West**
- **Reno**
- **Sequoyah**
- **NorthCare**
- **Pete White Wellness Center**
- **Britton Health Center**
- **Putnam City**







VARIETY CARE



VARIETY CARE		
1st Floor/Piso	1st Floor/Piso	2nd Floor/Piso
		23
		IVC
		Wash/Phis
		Diana Marmar, MD
		Laura Mook, MD
		Wendy L. Brown, MD
		Maria Arroyo
		Michelle M. Wood, MD
		Colleen Wood, MD
		Michelle Wood, MD
		Suzanne Perry, LPC
		Michelle Wood, MD



107th STREET MEDICAL CENTER

 **VARIETYCARE**
FAMILY HEALTH
MEDICAL CENTER

WALK-IN
PHYSICIAN
OFFICE

107





 VARIETY CARE

Call for an appointment: (405) 632-6688

 VARIETY CARE
HEALTH CENTERS

JOIN OUR TEAM

CLINIC & PHARMACY
DRIVE-THRU
NOW OPEN

(405) 632 - 6688

 VARIETY CARE
HEALTH CENTERS

Oklahoma Primary Care Association



VC at Baptist West Campus



Reno Health Center





Sequoya



PETE WHITE Wellness Center





Britton Family Resource Center

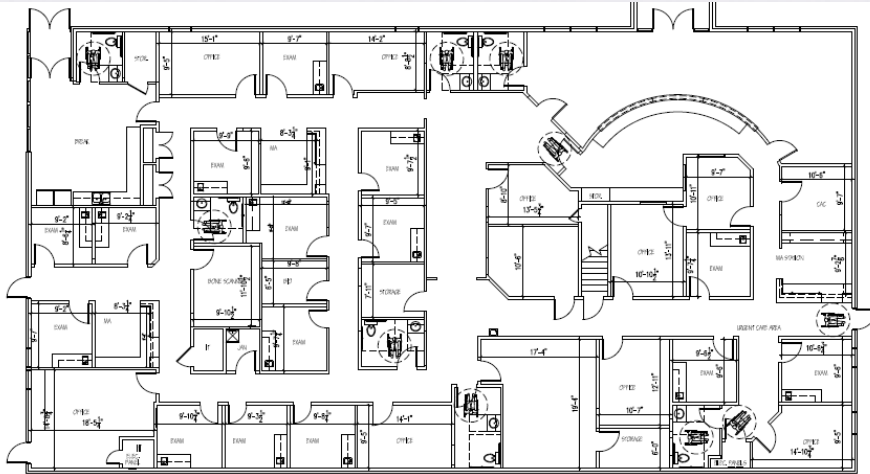



VARIETY CARE



Co-located clinics



care
center



A NORTHCARE COMMUNITY
A WHITEFIELDS LEGACY

- **Norman Himes Family Practice**
- **Norman Alameda Women and Children**



Variety Care





NORMAN PEDIATRIC CLINIC
VARIETY CARE



Spring Creek

Canadian County

YUKON

QUESTIONS?



VARIETY CARE

